

Spare parts for: Actuator plates Delta, for dual flush and stop-and-go flush
2005 -

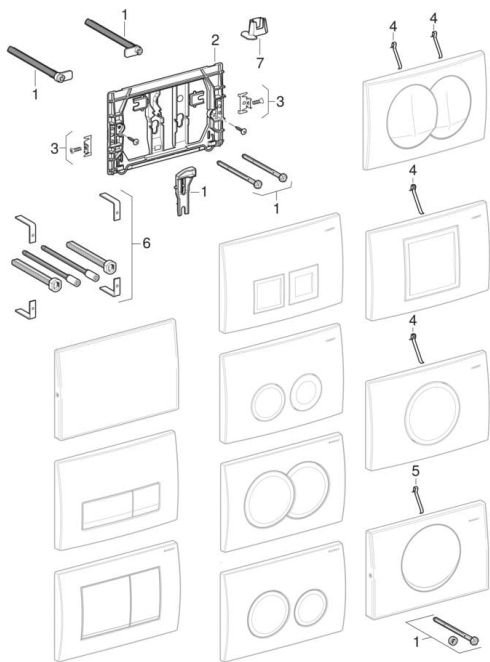

TYPE

Delta, Delta01, Delta10, Delta11, Delta15, Delta20, Delta21, Delta25, Delta30, Delta35, Delta40, Delta50, Delta51, Delta Zero

CHARACTERISTICS

Year of manufacture from 2005
Dimensions / Design Actuator plate: 24.6 x 16.4 cm

RELATED SPARE PARTS

- Delta concealed cisterns 12 cm (UP100)
- Delta concealed cisterns 8 cm (UP172)
- Overview actuator plates and cover plates for Delta concealed cisterns
- Delta concealed cisterns 12 cm (UP182)

INFO

- Only the listed articles are available

| # | Art. no. | Description |
|---|--------------|--|
| 1 | 241.465.00.1 | Geberit set of actuator rods for Delta concealed cistern |
| 2 | 242.274.00.1 | Geberit mounting frame for Delta actuator plate |

| # | Art. no. | Description |
|---|---------------------|---|
| 3 | 241.877.00.1 | Geberit fastening material for Sigma and Delta actuator plates |
| 4 | 241.295.00.1 | Geberit set of springs for actuator plate (10 pc.) |
| 5 | 813.514.00.1 | Geberit spring for actuator plate |
| 6 | 240.058.00.1 | Geberit extension set for Delta and Twinline concealed cisterns |
| 7 | 245.929.00.1 | Geberit top clip for stop-and-go flush for type 212 flushing system valve |

VALID FOR ARTICLES

- 115.100.11.1
- 115.100.21.1
- 115.100.46.1
- 115.101.00.1
- 115.103.00.1
- 115.120.11.1
- 115.120.21.1
- 115.120.46.1
- 115.125.11.1
- 115.125.21.1
- 115.125.46.1
- 115.130.11.1
- 115.130.21.1
- 115.130.46.1
- 115.135.11.1
- 115.135.21.1
- 115.135.46.1
- 115.105.11.1
- 115.105.21.1
- 115.105.46.1
- 115.107.11.1
- 115.107.21.1
- 115.107.46.1
- 115.127.11.1
- 115.127.46.1
- 115.127.21.1
- 115.137.11.1
- 115.137.21.1
- 115.137.46.1
- 115.109.11.1
- 115.109.21.1
- 115.109.46.1
- 115.108.00.1
- 115.119.11.1
- 115.119.21.1
- 115.119.46.1
- 115.119.DW.1
- 115.120.21.5
- 115.120.46.5
- 115.101.00.5
- 115.125.11.5
- 115.125.21.5
- 115.125.46.5
- 115.135.11.5
- 115.135.21.5
- 115.135.46.5
- 115.105.11.5
- 115.105.21.5
- 115.105.46.5
- 115.119.14.1